

KL-360T All-Rounder

30 Years of Craftsmanship in Manufacturing

NEW GENERATION

Middle Trunk Line Fusion Splicer

Description

- 4 Motor mainline fusion splicer
- Fiber core alignment, Fiber core visible
- Auto splice & auto heat function
- Fully ruggedized for shock, dust, and moisture
- 3-Year extended warranty
- 4.3-Inch capacitive touch screen
- Electrode life around 5000 times(Replaceable)
- Tool-less electrodes replacement
- 6800mAh High capacity battery with 300 splices&shrinks per charge



Automatic
welding heating



Functional
all-rounder



Tool-less
electrodes
replacement

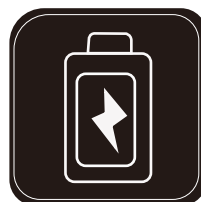

6800mAh High
capacity battery



Fiber core
visible



Touch display

Fusion splicer KL-360T

■ Main features



Oven with removable SOC clamp



Durable ceramic fiber pressure heads

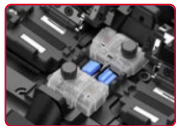

Fast-splicing 6s
Fast-heating 16s



The electrodes can be replaced by screwing it gently without tools



Special 3-in-1 fiber holder



Special designed V-groove

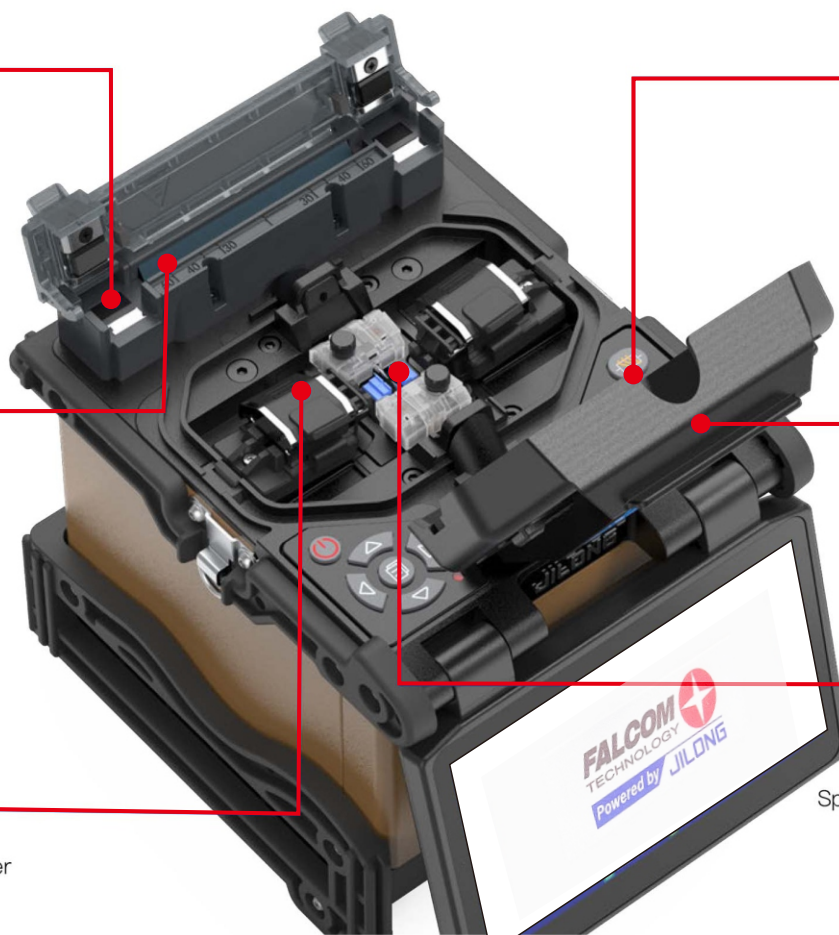

3-IN-1 Fiber Holder

Fiber holder suitable for bare fiber/ 3.0mm, jump fiber/ pigtail fiber/ FTTH fiber



High Expansibility fiber optic cleaver operating platform design

Support the placement of cleaver operating platform, do cleaving and splicing work in one step

(The console needs to be brought separately)

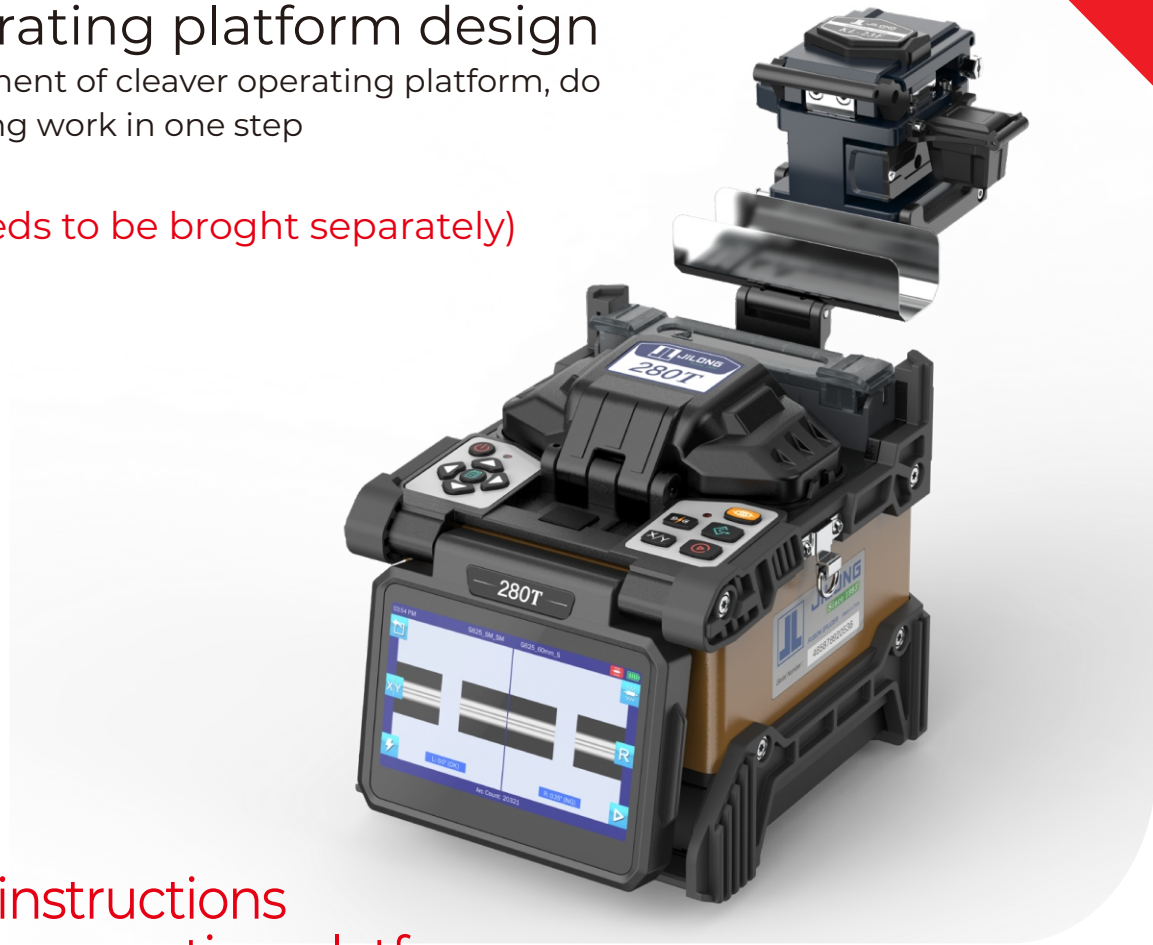

Installation instructions of fiber optic operating platform

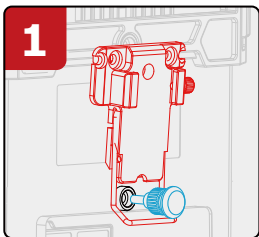

1 Use the screw to fix the base

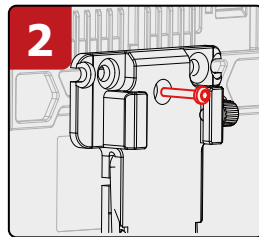

2 Finally, insert the screw into the middle hole on the upper part of the base and tighten it. The base installation is completed.

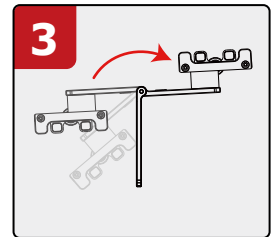

3 Rotate the support plate to the horizontal position

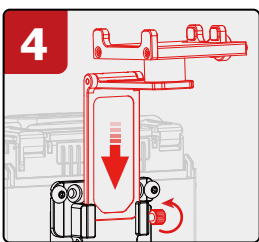

4 Insert into the base and tighten

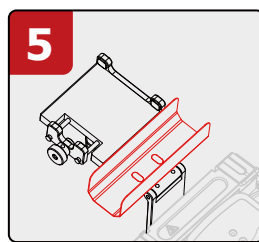

5 Place the cooling tray

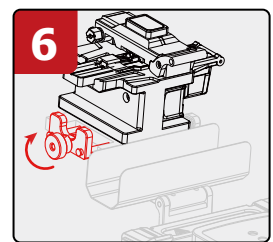

6 Fix the cleaver with the screw

Real core alignment

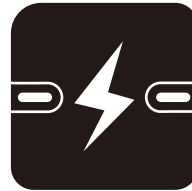
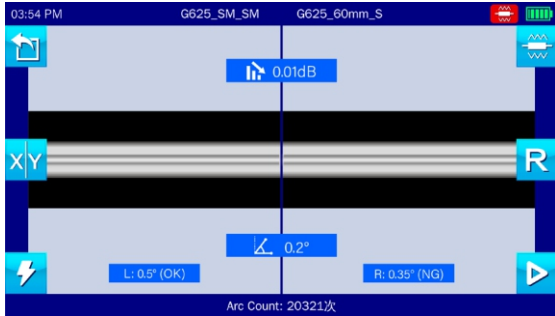

Fast-splicing 8s



Fast-heating 18s

6800mAh

High capacity Li-battery



6800mAh
capacity battery



300 splices &
shrinks per charge

High Expansibility fiber optic cleaver operating platform design

Support the placement of cleaver operating platform, do cleaving and splicing work in one step

(The console needs to be brought separately)



Installation instructions of fiber optic operating platform

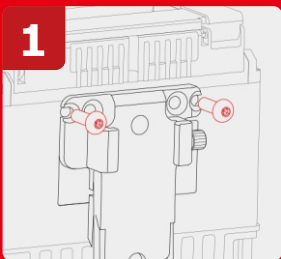

1 Use the screw to fix the base

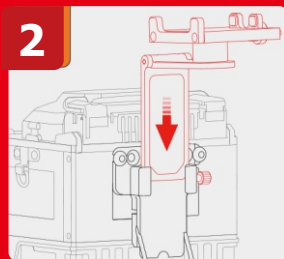

2 Insert into the base and tighten

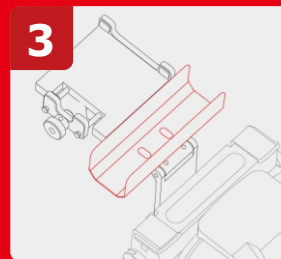

3 Place the cooling tray

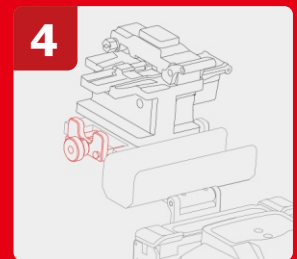

4 Fix the cleaver with the screw

Introduction of fiber optic cleaver operating platform

(The console needs to be bought separately)

Suitable for different models
fiber optic cleavers

Cooling tray can be
placed

Highly scalable

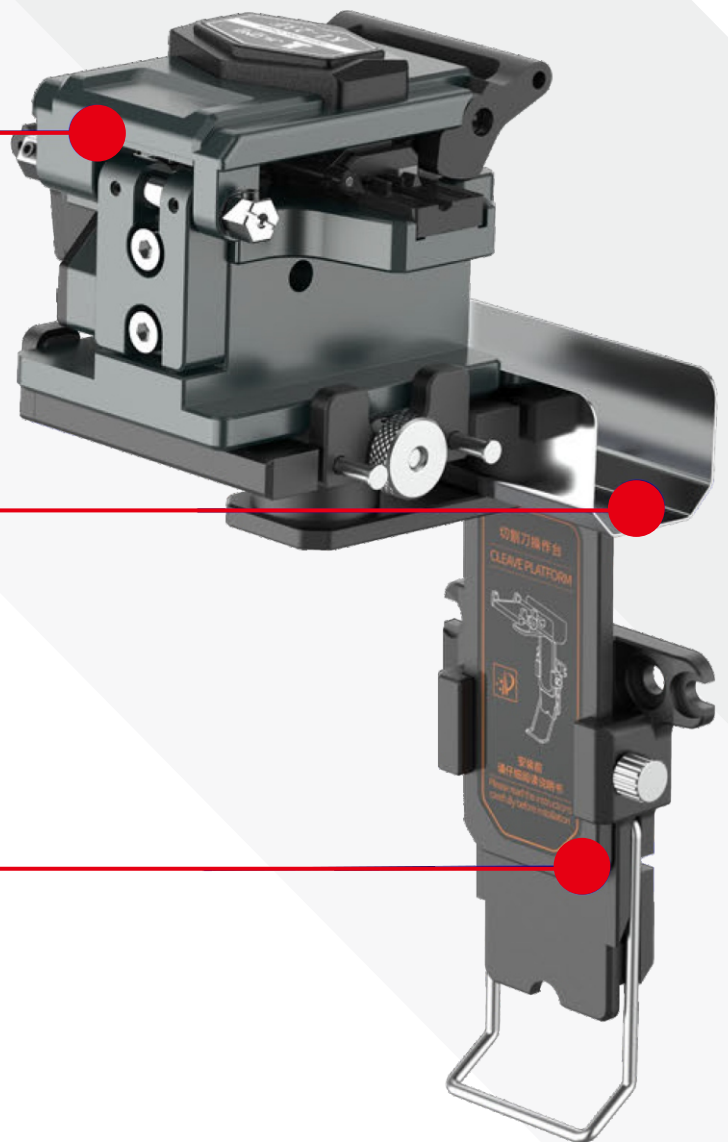

Fusion splicer KL-360T

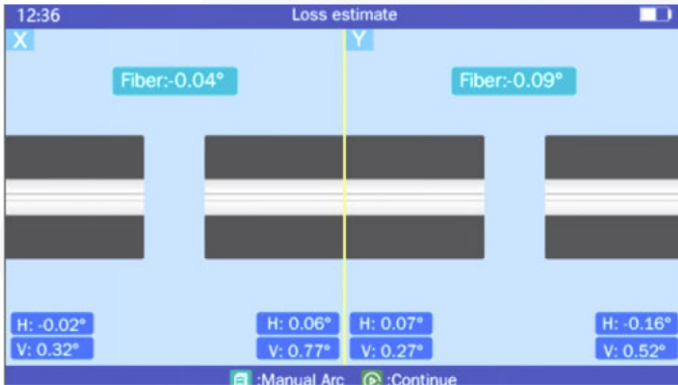

Fast-splicing
6s



Fast-heating
16s



300
splice & heat cycles



6 motor



5200mAh
battery capacity

■ Specification

| | |
|----------------------------------|---|
| Splice Method : | Active Clad-Alignment |
| Applicable Fibers : | SM(ITU-T G.652&G.657) / MM(ITU-T G.651) / DS(ITU-T G.653) / NZDS(ITU-T G.655) |
| Compatible Fiber/Cable : | 0.25~3.0 mm / indoor cable |
| Fiber Holder : | Replaceable (Universal: FH-60, SOC Holder: FH-SOC(optional)) |
| Fiber Diameter : | Cladding : 80-150 μ m , Coating: 100~1000 μ m |
| Fiber Cleave Length : | 8~16 mm |
| Splice mode : | Max 128 modes |
| Typical Splice Loss : | SM: 0.02dB / MM: 0.01dB / DS: 0.04dB / NZDS: 0.04dB / G.657: 0.02dB (* 1) |
| Return Loss : | >>60dB |
| Splicing Time : | SM Quick mode : 6 sec / SM Average: 16 Sec |
| Estimated Splice Loss : | Available |
| Heating Time : | Quick mode 16 sec.(SM G652 250 μ m 40mm Sleeve) adjustable |
| Protection Sleeve Length : | 20mm, 30mm, 40mm, 50mm, 60mm |
| Heat Programs: | Max 32 modes |
| Battery : | 5200mAh Battery Capacity, Typical 300 Cycles (Splice&Heat) per Charge (* 2) |
| Electrode Life : | 5000 arcs (replaceable) (* 3) |
| Auto-start : | Splice / Heating |
| Automatic Fiber Identification : | SMF / MMF / other |
| Automatic ARC Identification : | Automatic arc calibration by air pressure and temperature |
| Results Storage : | The last 10,000 splice records and 2,000 result images |
| Tension Test : | 1.96~2.25N |
| Operating Condition : | Altitude: 0~5000m, 0~95% relative humidity, -20~50°C, Max Wind 15m/s |
| Storage Condition : | 0~95% relative humidity, -20~60°C |
| Display : | 5.0" color high resolution (800 x 480) display |
| Fiber Magnification : | X, Y, XY, X/Y : 320X Magnification |
| Power Supply : | AC Input 100-240V, DC 9-14V |
| Terminal : | USB2.0 |
| Weight : | 1.6kg without battery / 1.9kg with battery |
| Size : | 138H x 160W x 150D mm (including rubber bumper) |

* 1 With identical fibres(in room temperature). Measured by cut-back method relevant to ITU-T and IEC standards.

* 2 Splice & Heat cycles may vary depending on the battery status and the operating environment.

* 3 Electrode life may vary depending on the operating environment.

■ Product display



■ Packing list

